

HYBRID MODULAR CUSTOMISED COMPONENTS:

- KITCHEN
- BATHROOM
- EVAPORATION CHANNEL
- LADDER + KURA SPACE
- ALGAE THERMAL MASS TUBES
- GREEN TUBES

MASS CUSTOMISED OPTIONS FOR DEMATERIALISABLE WALL PANELS

- (1) Recycled Timber
- (2) Recycled Metal
- (3) Bio-degradable Plastic
- (4) Recycled Glass

U.S adults personally taken action to help address climate change within year 2020-2021.  
Source: PEW Research Center 2021

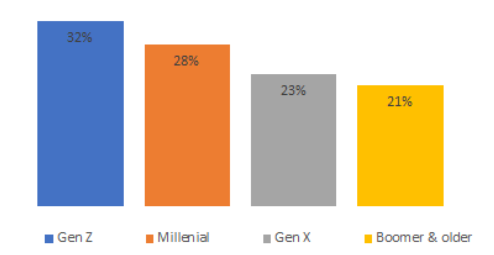

TARGET GROUP:

**MILLENNIALS = ECO-ANXIETY**

- SUSTAINABLE LIFESTYLE
- ZERO-ENERGY
  - ZERO-CARBON
  - GROW OWN FOOD
  - COST EFFECTIVE
- MICROHOMES

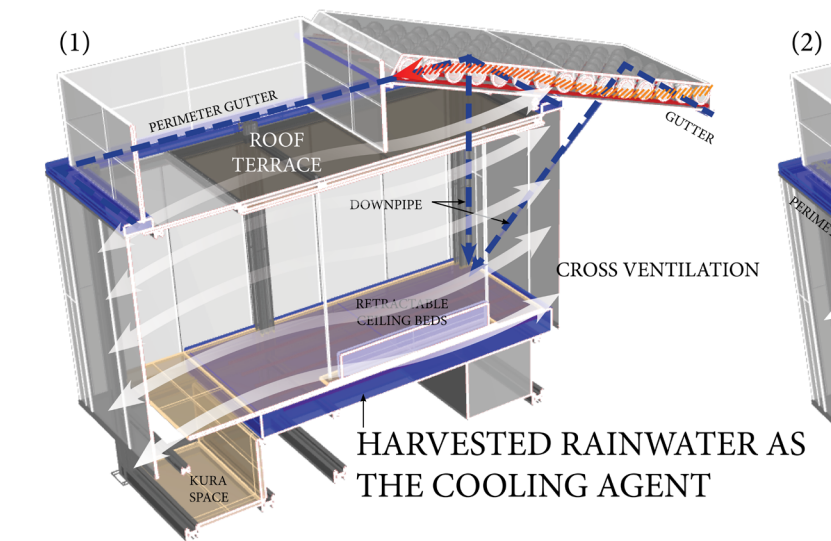

**SPRING/SUMMER:  
COOLING SYSTEM**

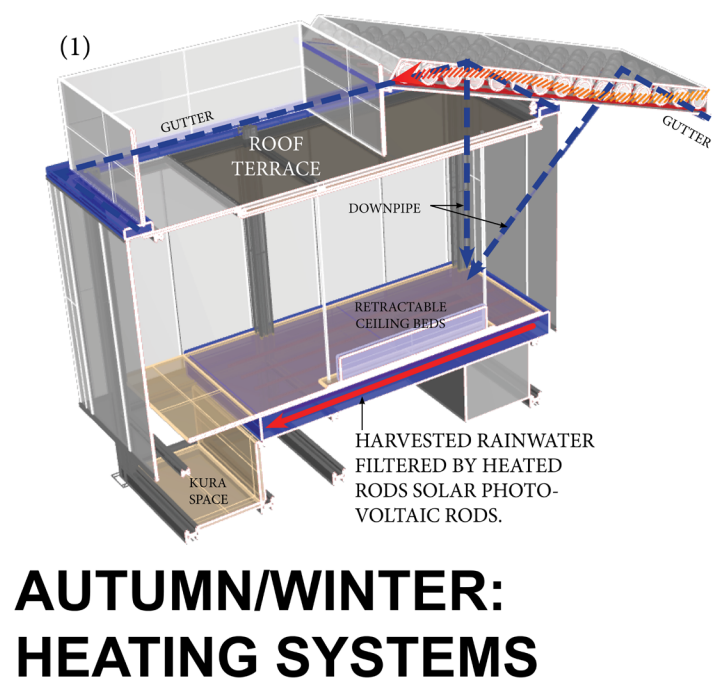
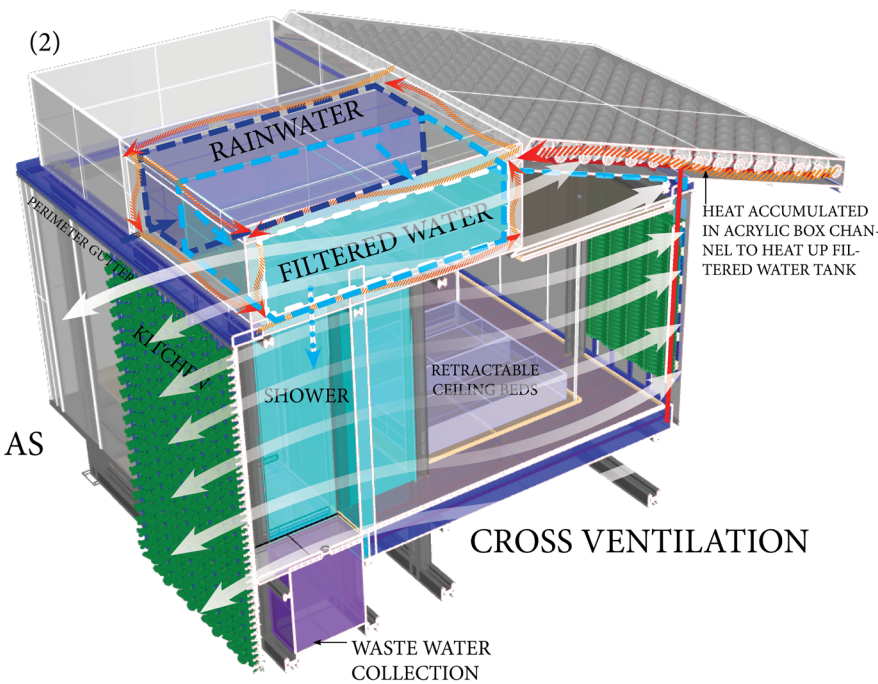

**AUTUMN/WINTER:  
HEATING SYSTEMS**

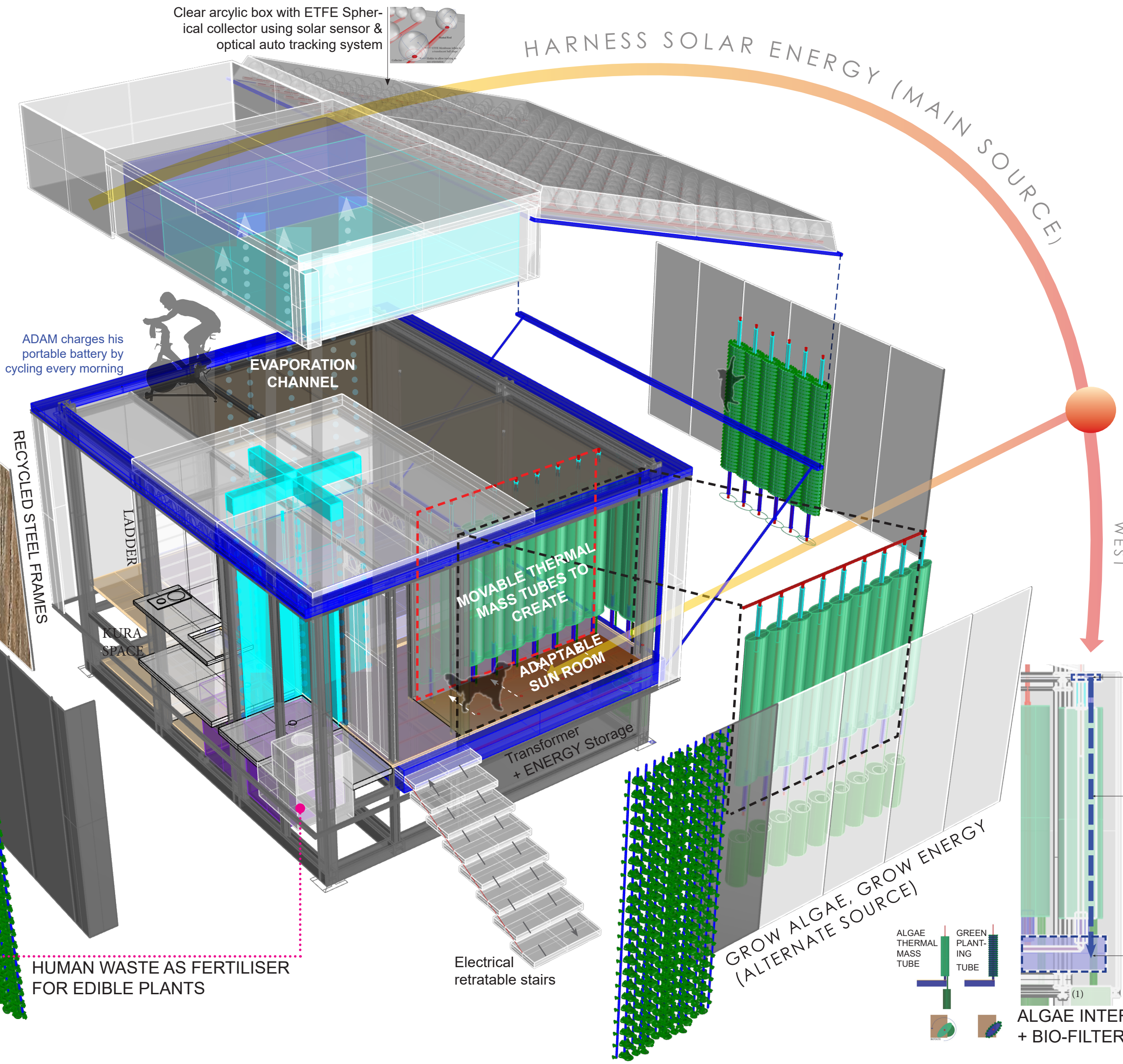
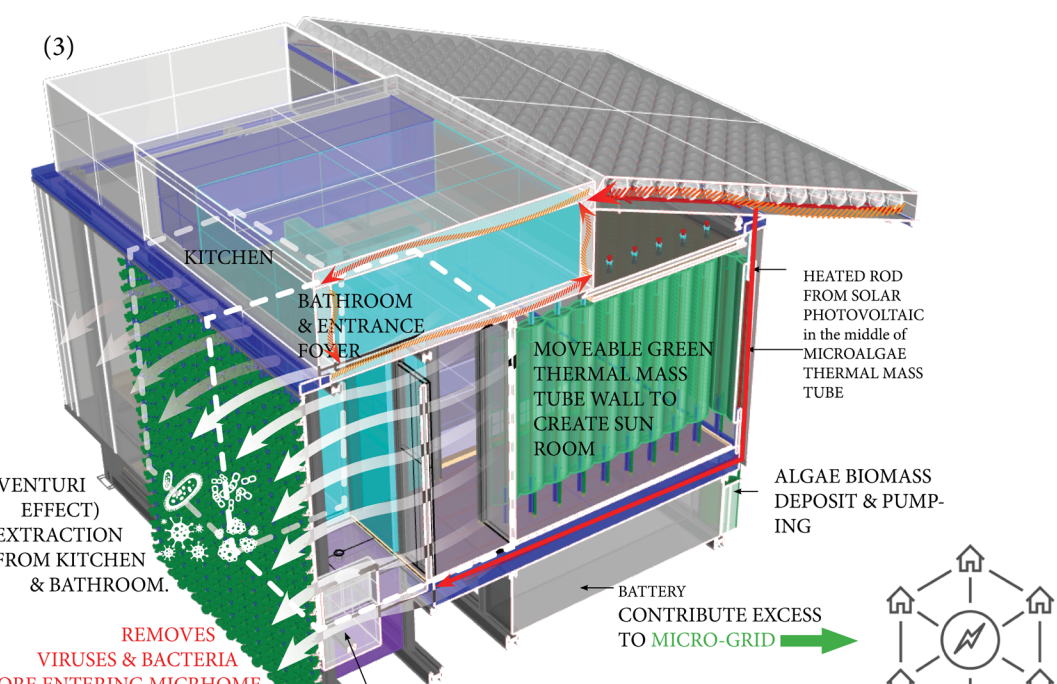
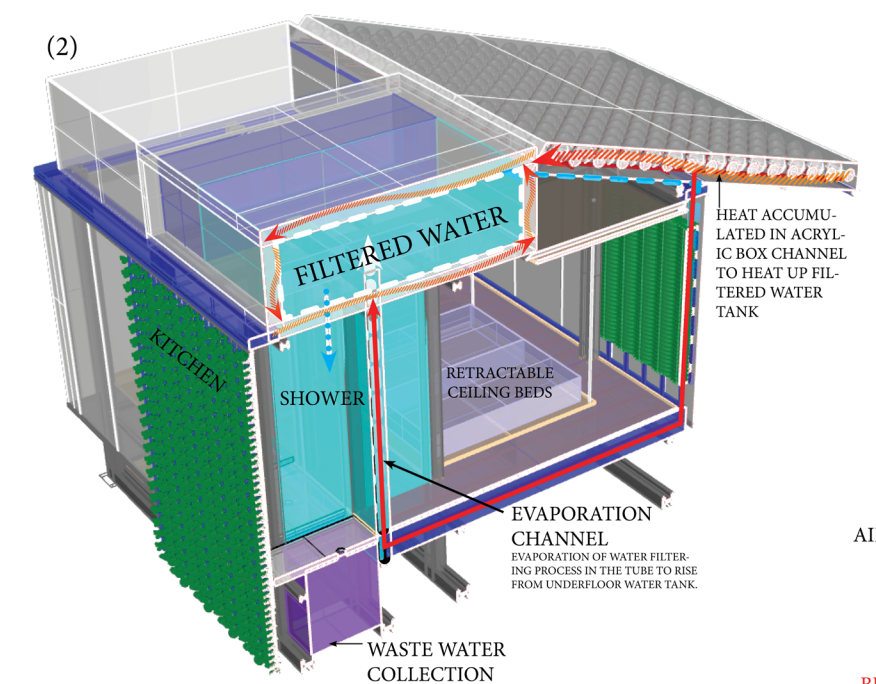

HUMAN WASTE AS FERTILISER FOR EDIBLE PLANTS

